



\$99,999.99

CBYH 395 Model Home for Sale

Discover Freedom in Minimalism

Listing Description

We are selling our 395 model home!! Embrace a lifestyle of simplicity and sustainability with our stunning 395 sq. ft. tiny home. Perfect for those seeking a cozy retreat, a primary residence, or an investment opportunity, this home is designed for modern living without the clutter.



1

Bedrooms



1

Bathrooms



384

Square Feet

Model Home Summary

Key Features

- Efficient Design: Smart layout maximizing space and functionality.
- High-Quality Materials: Built with durable, eco-friendly materials ensuring longevity and comfort.
- Energy Efficient: Equipped with energy-saving appliances and insulation, reducing your carbon footprint.

Why Choose a Backyard Home?

- Affordability: Lower mortgage payments and reduced utility costs.
- Simplicity: Live with less and focus on what truly matters.
- Mobility: This unit is ready to be shipped!
- Sustainable Living: Minimize your environmental impact with a smaller footprint.

Perfect For

- First-time Homebuyers: An affordable entry into homeownership.
- Retirees: A manageable space for a peaceful lifestyle.
- Investors: A lucrative rental option in a growing market.

Contact Information:

Website: cbyh.ca/395-sq-ft-tiny-home
Phone: 519-518-CBYH (2294)
Email: info@cbyh.ca

Experience the charm and practicality of tiny living. Contact us today to schedule a tour or learn more about how you can make this tiny home your own!

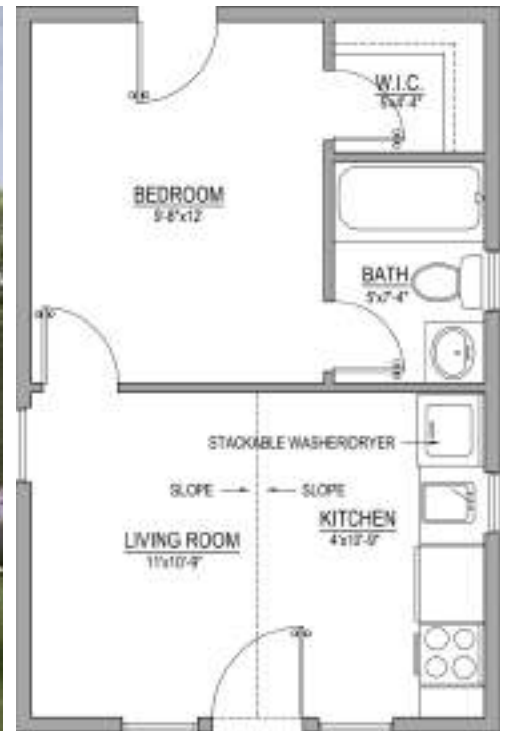

\$99,999.99

CBYH 395 Model Home for Sale

Discover Freedom in Minimalism

1640 FANSHAWE PARK RD W. LONDON. ON.

Website: cbyh.ca/395-sq-ft-tiny-home

Phone: 519-518-CBYH (2294)

Email: info@cbyh.ca

 1 Bedrooms
 1 Bathrooms
 384 Square Feet

Model Home Summary

Building Type Accessory Dwelling Unit (ADU) / Detached Dwelling	Square Footage 384 sq.ft.	Home Size 16' x 24'
Municipality London	Age Of Building Constructed in 2022	Storeys 1
Building Features Ontario Building Code compliant Installed kitchen & bath with laminate countertops Fully finished interior: flooring, paint, lighting, trim, and doors Steel entry doors Services: Electrical, Plumbing, HVAC – roughed in and ready for hookup Constructed on steel beams for easy moving Asphalt shingles James Hardie siding Appliances	Listing Exclusions Shipping (quote based on delivery address) Building permits Hook-up Services: Electrical, Plumbing, Sanitary Helical Pile Foundation Furniture Rooms Living room 11' x 10'-9" Kitchen 4' x 10'-9" Bedroom 9'-8" x 12' Bathroom 5' x 4'-4" Walk-in Closet 5' x 7'-4"	



Living room & Kitchen

Email: info@cbyh.ca

 1
  1
  384
 Bedrooms Bathrooms Square Feet

\$99,999.99



Bedroom & Bathroom

Email: info@cbyh.ca

 1	 1	 384
Bedrooms	Bathrooms	Square Feet

\$99,999.99



Exterior & Finishes

Email: info@cbyh.ca

 1  1  384
Bedrooms Bathrooms Square Feet

\$99,999.99